

# STONEBRIDGE

Independent Estate Agents

7, Westbrook Road,  
Evercreech, BA4 6LR



A charming 3 bedroom bungalow in a cul-de-sac with front and rear gardens, garage and parking. No on-ward chain

**Guide Price: £228,000**



[www.stonebridgesouthwest.co.uk](http://www.stonebridgesouthwest.co.uk)

Tel: 01749 330400 Fax: 01749 334370  
33 High Street Shepton Mallet BA4 5AQ

## Details

- \* Detached bungalow
- \* Kitchen/Breakfast room
- \* Garage & off road parking
- \* Three bedrooms
- \* Utility room
- \* Front & Rear gardens

A charming, 3 bedroom, well maintained, detached bungalow situated in a cul-de-sac. Accommodation comprises: Living room, kitchen/diner, utility room, three bedrooms and a bathroom. There is an integral garage and additional off road parking. The property benefits from gardens on three sides.

## Outside

To the front there is a driveway leading to the garage and a path to the front door. The front garden is laid mainly to lawn with borders of plants and shrubs. There is gated side access to the rear and side gardens. The rear gardens are laid mainly to lawn and contain a shed and greenhouse.

## Services

All main services. Central heating system uses Oil.

## Tenure

Freehold

## Local Authority

Mendip District Council

## Evercreech

Evercreech sits between Shepton Mallet (approx 3 miles) and Castle Cary with its rail connections to Bath and London (approx 5 miles). There are several pubs in the village, some of which also provide food. Shops include a small Co-op, a pharmacy, doctors, post office, abakers, a fish and chip shop and a hair salon.

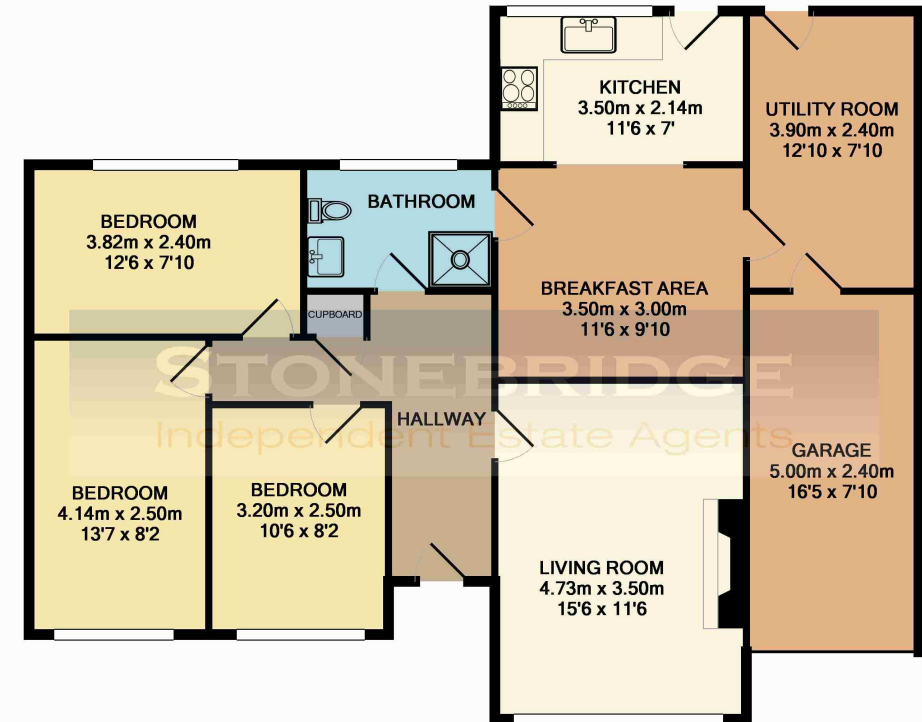

TOTAL APPROX. FLOOR AREA 97.2 SQ.M. (1046 SQ.FT.)  
Measurements are approximate. Not to scale. Illustrative purposes only  
Made with Metropix ©2008